

GELIBOLU PARADE

PERCY STREET

1 GROUND FLOOR  
1:200

EXISTING LAYOUT

Rev	Date	Amendment	By	Rev	Date	Amendment	By

GENERAL NOTES  
 1. ALL DIMENSIONS AND SIZES ARE IN MILLIMETRES.  
 2. DO NOT SCALE DRAWINGS.  
 3. ALL WALL THICKNESSES DIMENSIONED OR NOTED ARE NOMINAL SIZES ONLY.  
 4. INFORMATION INDICATED IN THIS DOCUMENT MAY BE CRUCIAL TO THE SAFE AND PROPER FUNCTIONING OF THE PROJECT. DO NOT ALTER ANY ASPECT WITHOUT REFERENCE TO THE ARCHITECT.  
 5. READ THIS DRAWING IN CONJUNCTION WITH RELEVANT CONSULTANT DRAWINGS AND SPECIFICATIONS.  
 6. INFORM THE ARCHITECT OF ANY DISCREPANCIES.

- THE WORK IS TO BE COMPLETED WITH THE BUILDING CODE OF AUSTRALIA, SAA CODES AND RELEVANT BY-LAWS.  
 - THE BUILDING / MANUFACTURER SHALL CHECK AND VERIFY ALL DIMENSIONS, RL, GROUND LINES AND CONSTRUCTION METHODS PRIOR TO COMMENCEMENT OF WORK.  
 - PREFERENCES OF DIMENSIONED MEASUREMENT TO BE TAKEN OVER SCALED MEASUREMENTS.  
 - A COPY OF THIS PLAN IS TO BE SUBMITTED BY THE PROPRIETOR TO THE WATERBOARD FOR APPROVAL AS REQUIRED BY THE LOCAL COUNCIL.

ARCHITECTURE DESIGN STUDIO PTY LTD  
 ABN: 43 159 401 420  
 43/8 Avenue Of The Americas  
 Newington, NSW 2127  
 Phone: 02 9648 6663 | Fax: 02 9648 6664  
 email: info@ad-s.com.au

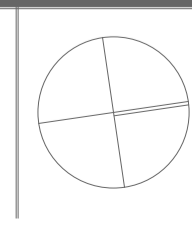

This drawing is protected by copyright. It may only be used for the purpose for which it is issued.  
 A1 Scale 1:200 A3 Scale 1:400  
 0 1 2 3 4 5 10m

Client: Australian Turkish Maarif Foundation Limited  
 Project: Private Educational Institution  
 Address: 2 PERCY STREET AUBURN NSW 2144 AUSTRALIA

Drawing Title	Project No.
Existing Ground Level	Pn_0648
Date: 19/06/2017	Checked: IS
Drawing No: A-FE-111-001	Revision: A

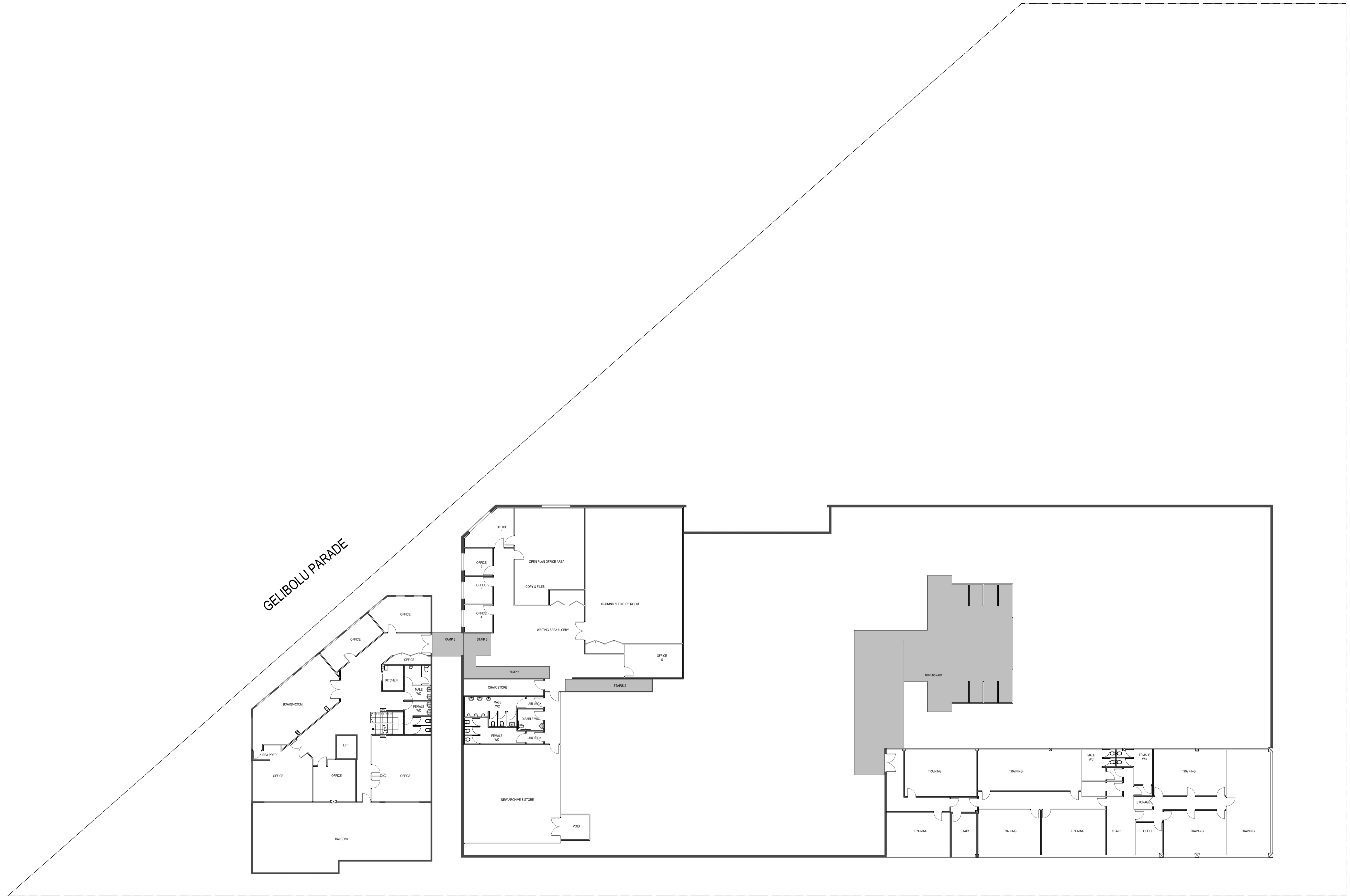

GELIBOLU PARADE

PERCY STREET

1 FIRST FLOOR  
1:200

**EXISTING LAYOUT**

Rev	Date	Amendment	By	Rev	Date	Amendment	By

GENERAL NOTES  
 1. ALL DIMENSIONS AND SIZES ARE IN MILLIMETRES.  
 2. DO NOT SCALE DRAWINGS.  
 3. ALL WALL THICKNESSES DIMENSIONED OR NOTED ARE NOMINAL SIZES ONLY.  
 4. INFORMATION INDICATED IN THIS DOCUMENT MAY BE CRUCIAL TO THE SAFE AND PROPER FUNCTIONING OF THE PROJECT. DO NOT ALTER ANY ASPECT WITHOUT REFERENCE TO THE ARCHITECT.  
 5. READ THIS DRAWING IN CONJUNCTION WITH RELEVANT CONSULTANT DRAWINGS AND SPECIFICATIONS.  
 6. INFORM THE ARCHITECT OF ANY DISCREPANCIES.

- THE WORK IS TO BE COMPLETED WITH THE BUILDING CODE OF AUSTRALIA, SAA CODES AND RELEVANT BY-LAWS.  
 - THE BUILDING / MANUFACTURER SHALL CHECK AND VERIFY ALL DIMENSIONS, RL, GROUND LINES AND CONSTRUCTION METHODS PRIOR TO COMMENCEMENT OF WORK.  
 - PREFERENCES OF DIMENSIONED MEASUREMENT TO BE TAKEN OVER SCALED MEASUREMENTS.  
 - A COPY OF THIS PLAN IS TO BE SUBMITTED BY THE PROPRIETOR TO THE WATERBOARD FOR APPROVAL AS REQUIRED BY THE LOCAL COUNCIL.

ARCHITECTURE DESIGN STUDIO PTY LTD  
 ABN: 43 159 401 420  
 43/8 Avenue Of The Americas  
 Newington, NSW 2127  
 Phone: 02 9648 6663 | Fax: 02 9648 6664  
 email: info@ad-s.com.au

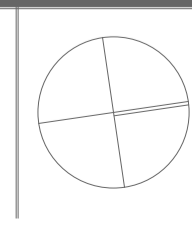

This drawing is protected by copyright. It may only be used for the purpose for which it is issued.

A1 Scale 1:500    A3 Scale 1:100

Client: Australian Turkish Maarif Foundation Limited  
 Project: Private Educational Institution  
 Address: 2 PERCY STREET AUBURN NSW 2144 AUSTRALIA

Drawing Title	Project No.
Existing FIRST FLOOR	Pn_0648
Date: 19/06/2017	Checked: IS
Drawing No: A-FE-111-002	Revision: A

1 FIRST FLOOR - GFA  
1:200

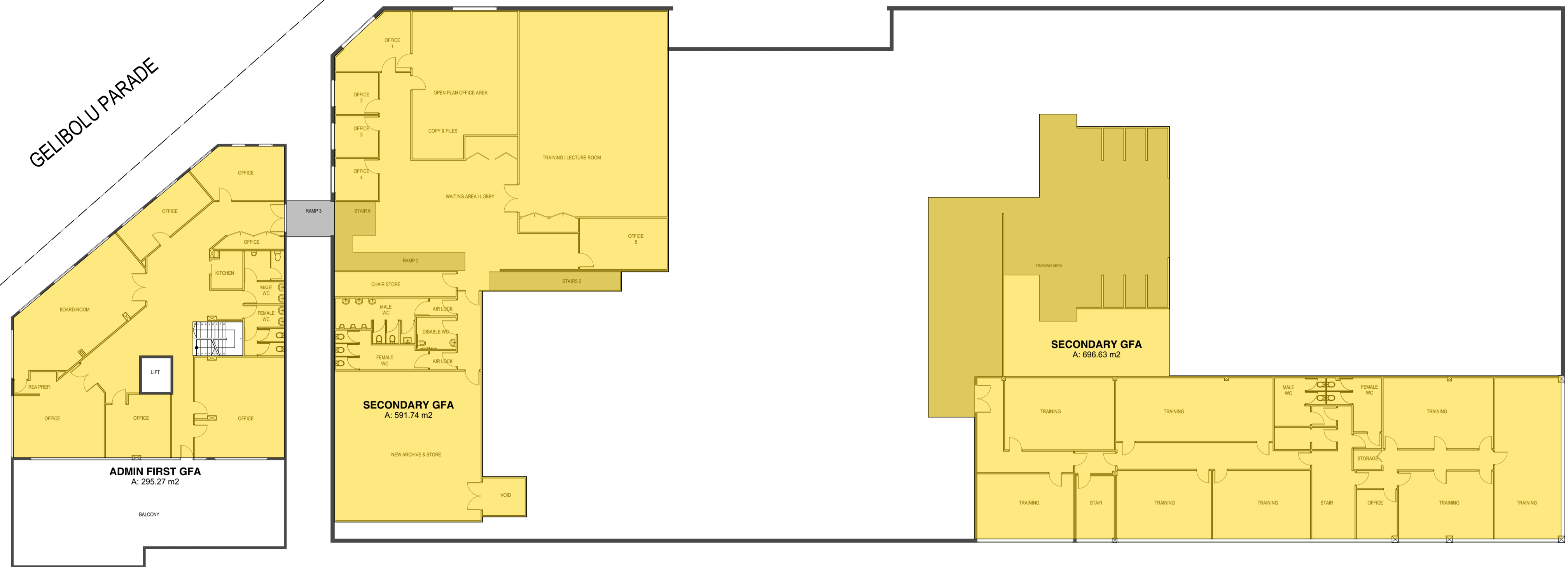

1 GROUND FLOOR - GFA  
1:200

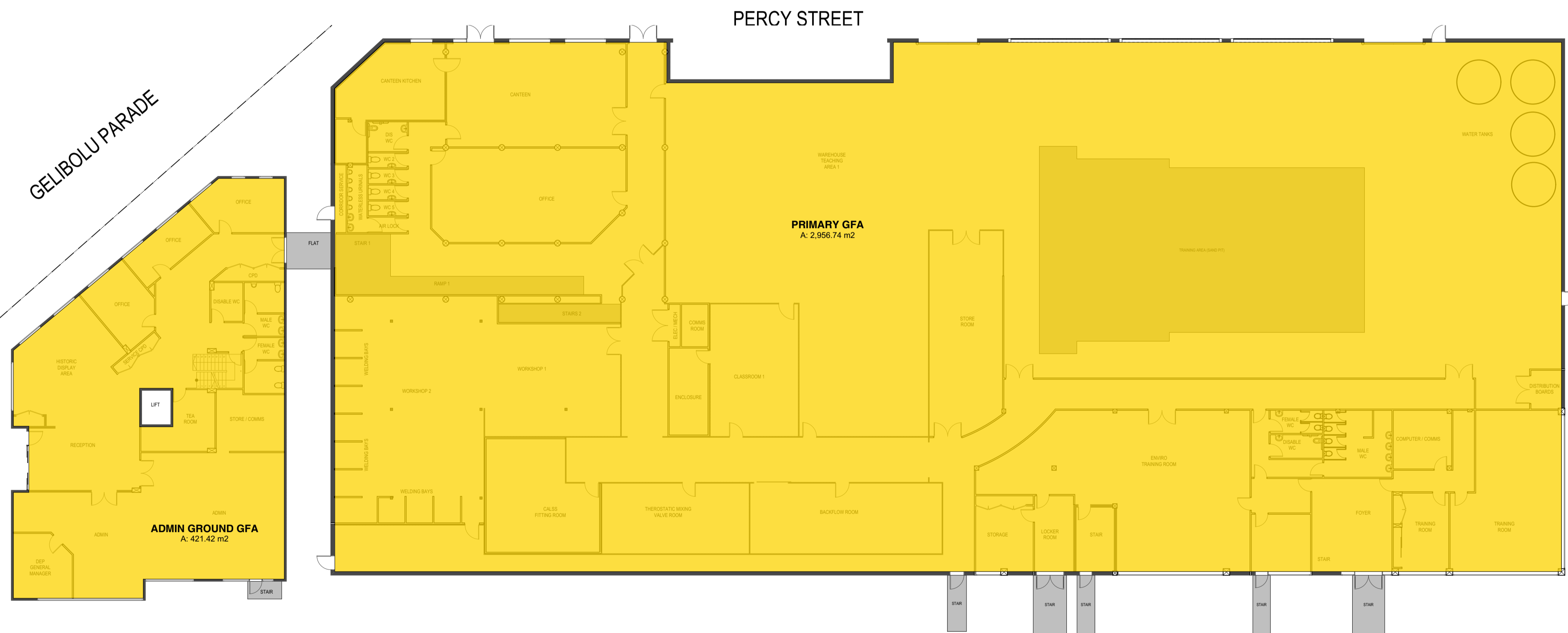

**SITE AREA 7142.7**  
**TOTAL GFA 4961.8**  
**FSR 0.69:1**  
**EXISTING LAYOUT**

Rev	Date	Amendment	By	Rev	Date	Amendment	By

**GENERAL NOTES**  
1. ALL DIMENSIONS AND SIZES ARE IN MILLIMETRES.  
2. DO NOT SCALE DRAWINGS.  
3. ALL WALL THICKNESSES DIMENSIONED OR NOTED ARE NOMINAL SIZES ONLY.  
4. INFORMATION INDICATED IN THIS DOCUMENT MAY BE CRUCIAL TO THE SAFE AND PROPER FUNCTIONING OF THE PROJECT. DO NOT ALTER ANY ASPECT WITHOUT REFERENCE TO THE ARCHITECT.  
5. READ THIS DRAWING IN CONJUNCTION WITH RELEVANT CONSULTANT DRAWINGS AND SPECIFICATIONS.  
6. INFORM THE ARCHITECT OF ANY DISCREPANCIES.

- THE WORK IS TO BE COMPLETED WITH THE BUILDING CODE OF AUSTRALIA, SAA CODES AND RELEVANT BY-LAWS.  
- THE BUILDING / MANUFACTURER SHALL CHECK AND VERIFY ALL DIMENSIONS, RL, GROUND LINES AND CONSTRUCTION METHODS PRIOR TO COMMENCEMENT OF WORK.  
- PREFERENCES OF DIMENSIONED MEASUREMENT TO BE TAKEN OVER SCALED MEASUREMENTS.  
- A COPY OF THIS PLAN IS TO BE SUBMITTED BY THE PROPRIETOR TO THE WATERBOARD FOR APPROVAL AS REQUIRED BY THE LOCAL COUNCIL.

ARCHITECTURE DESIGN STUDIO PTY LTD  
ABN: 43 159 401 420  
43/8 Avenue Of The Americas  
Newington, NSW 2127  
Phone: 02 9648 6663 | Fax: 02 9648 6664  
email: info@ad-s.com.au

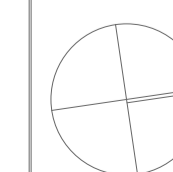

This drawing is protected by copyright. It may only be used for the purpose for which it is issued.  
A1 Scale 1:500 A3 Scale 1:400  
0 1 2 3 4 5 10m

Client: Australian Turkish Maarif Foundation Limited  
Project: Private Educational Institution  
Address: 2 PERCY STREET AUBURN NSW 2144 AUSTRALIA

Drawing Title: Existing GFA  
Date: 19/06/2017  
Drawing No: A-FE-111-003

Project No: Pn\_0648  
Checked: IS  
Revision: A





1 GROUND FLOOR  
1:200

**PROPOSED LAYOUT**

Rev	Date	Amendment	By	Rev	Date	Amendment	By

GENERAL NOTES  
 1. ALL DIMENSIONS AND SIZES ARE IN MILLIMETRES.  
 2. DO NOT SCALE DRAWINGS.  
 3. ALL WALL THICKNESSES DIMENSIONED OR NOTED ARE NOMINAL SIZES ONLY.  
 4. INFORMATION INDICATED IN THIS DOCUMENT MAY BE CRUCIAL TO THE SAFE AND PROPER FUNCTIONING OF THE PROJECT. DO NOT ALTER ANY ASPECT WITHOUT REFERENCE TO THE ARCHITECT.  
 5. READ THIS DRAWING IN CONJUNCTION WITH RELEVANT CONSULTANT DRAWINGS AND SPECIFICATIONS.  
 6. INFORM THE ARCHITECT OF ANY DISCREPANCIES.

- THE WORK IS TO BE COMPLETED WITH THE BUILDING CODE OF AUSTRALIA, SAA CODES AND RELEVANT BY-LAWS.  
 - THE BUILDING / MANUFACTURER SHALL CHECK AND VERIFY ALL DIMENSIONS, RL, GROUND LINES AND CONSTRUCTION METHODS PRIOR TO COMMENCEMENT OF WORK.  
 - PREFERENCES OF DIMENSIONED MEASUREMENT TO BE TAKEN OVER SCALED MEASUREMENTS.  
 - A COPY OF THIS PLAN IS TO BE SUBMITTED BY THE PROPRIETOR TO THE WATERBOARD FOR APPROVAL AS REQUIRED BY THE LOCAL COUNCIL.

ARCHITECTURE DESIGN STUDIO PTY LTD  
 ABN: 43 159 401 420  
 43/8 Avenue Of The Americas  
 Newington, NSW 2127  
 Phone: 02 9648 6663 | Fax: 02 9648 6664  
 email: info@ad-s.com.au

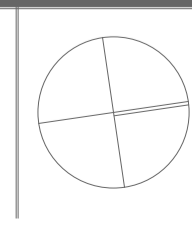

This drawing is protected by copyright. It may only be used for the purpose for which it is issued.  
 A1 Scale 1:200 A3 Scale 1:400  
 0 1 2 3 4 5 10m

Client: Australian Turkish Maarif Foundation Limited  
 Project: Private Educational Institution  
 Address: 2 PERCY STREET AUBURN NSW 2144 AUSTRALIA

Drawing Title		Project No.	
Proposed Ground Level		Pn_0648	
Date	19/06/2017	Checked	ES
Drawing No.	A-FE-111-004	Revision	A



GELIBOLU PARADE

PERCY STREET

1 FIRST FLOOR  
1:200

**PROPOSED LAYOUT**

Rev	Date	Amendment	By	Rev	Date	Amendment	By

GENERAL NOTES  
 1. ALL DIMENSIONS AND SIZES ARE IN MILLIMETRES.  
 2. DO NOT SCALE DRAWINGS.  
 3. ALL WALL THICKNESSES DIMENSIONED OR NOTED ARE NOMINAL SIZES ONLY.  
 4. INFORMATION INDICATED IN THIS DOCUMENT MAY BE CRUCIAL TO THE SAFE AND PROPER FUNCTIONING OF THE PROJECT. DO NOT ALTER ANY ASPECT WITHOUT REFERENCE TO THE ARCHITECT.  
 5. READ THIS DRAWING IN CONJUNCTION WITH RELEVANT CONSULTANT DRAWINGS AND SPECIFICATIONS.  
 6. INFORM THE ARCHITECT OF ANY DISCREPANCIES.

- THE WORK IS TO BE COMPLETED WITH THE BUILDING CODE OF AUSTRALIA, SAA CODES AND RELEVANT BY-LAWS.  
 - THE BUILDING / MANUFACTURER SHALL CHECK AND VERIFY ALL DIMENSIONS, RL, GROUND LINES AND CONSTRUCTION METHODS PRIOR TO COMMENCEMENT OF WORK.  
 - PREFERENCES OF DIMENSIONED MEASUREMENT TO BE TAKEN OVER SCALED MEASUREMENTS.  
 - A COPY OF THIS PLAN IS TO BE SUBMITTED BY THE PROPRIETOR TO THE WATERBOARD FOR APPROVAL AS REQUIRED BY THE LOCAL COUNCIL.

ARCHITECTURE DESIGN STUDIO PTY LTD  
 ABN: 43 159 401 420  
 43/8 Avenue Of The Americas  
 Newington, NSW 2127  
 Phone: 02 9648 6663 | Fax: 02 9648 6664  
 email: info@ad-s.com.au

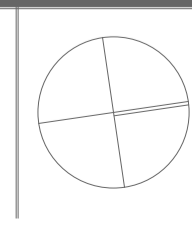

This drawing is protected by copyright. It may only be used for the purpose for which it is issued.  
 A1 Scale 1:200 A3 Scale 1:400  
 0 1 2 3 4 5 10m

Client: Australian Turkish Maarif Foundation Limited  
 Project: Private Educational Institution  
 Address: 2 PERCY STREET AUBURN NSW 2144 AUSTRALIA

Drawing Title	Proposed FIRST FLOOR	Project No.	Pn_0648
Date	19/06/2017	Checked	ES
Drawing No.	A-FE-111-005	Revision	A



1 SECOND FLOOR  
1:200

**PROPOSED LAYOUT**

Rev	Date	Amendment	By	Rev	Date	Amendment	By

GENERAL NOTES  
 1. ALL DIMENSIONS AND SIZES ARE IN MILLIMETRES.  
 2. DO NOT SCALE DRAWINGS.  
 3. ALL WALL THICKNESSES DIMENSIONED OR NOTED ARE NOMINAL SIZES ONLY.  
 4. INFORMATION INDICATED IN THIS DOCUMENT MAY BE CRUCIAL TO THE SAFE AND PROPER FUNCTIONING OF THE PROJECT. DO NOT ALTER ANY ASPECT WITHOUT REFERENCE TO THE ARCHITECT.  
 5. READ THIS DRAWING IN CONJUNCTION WITH RELEVANT CONSULTANT DRAWINGS AND SPECIFICATIONS.  
 6. INFORM THE ARCHITECT OF ANY DISCREPANCIES.

- THE WORK IS TO BE COMPLETED WITH THE BUILDING CODE OF AUSTRALIA, SAA CODES AND RELEVANT BY-LAWS.  
 - THE BUILDING / MANUFACTURER SHALL CHECK AND VERIFY ALL DIMENSIONS, RL, GROUND LINES AND CONSTRUCTION METHODS PRIOR TO COMMENCEMENT OF WORK.  
 - PREFERENCES OF DIMENSIONED MEASUREMENT TO BE TAKEN OVER SCALED MEASUREMENTS.  
 - A COPY OF THIS PLAN IS TO BE SUBMITTED BY THE PROPRIETOR TO THE WATERBOARD FOR APPROVAL AS REQUIRED BY THE LOCAL COUNCIL.

ARCHITECTURE DESIGN STUDIO PTY LTD  
 ABN: 43 159 401 420  
 43/8 Avenue Of The Americas  
 Newington, NSW 2127  
 Phone: 02 9648 6663 | Fax: 02 9648 6664  
 email: info@ad-s.com.au

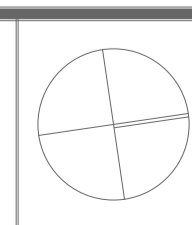

This drawing is protected by copyright. It may only be used for the purpose for which it is issued.

A1 Scale 1:200    A3 Scale 1:400

Client: Australian Turkish Maarif Foundation Limited  
 Project: Private Educational Institution  
 Address: 2 PERCY STREET AUBURN NSW 2144 AUSTRALIA

Drawing Title: Proposed SECOND FLOOR  
 Date: 19/06/2017  
 Drawing No: A-FE-111-006  
 Project No: Pn\_0648  
 Checked: IS  
 Revision: A

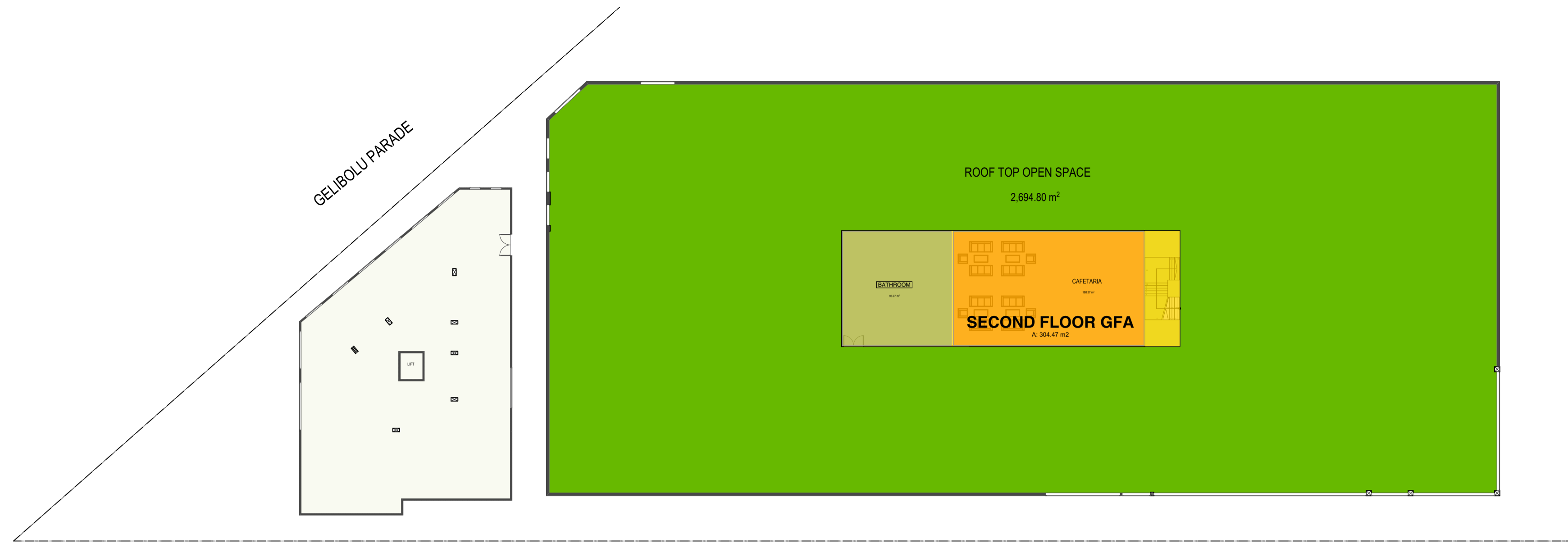

1 SECOND FLOOR - GFA  
1:300

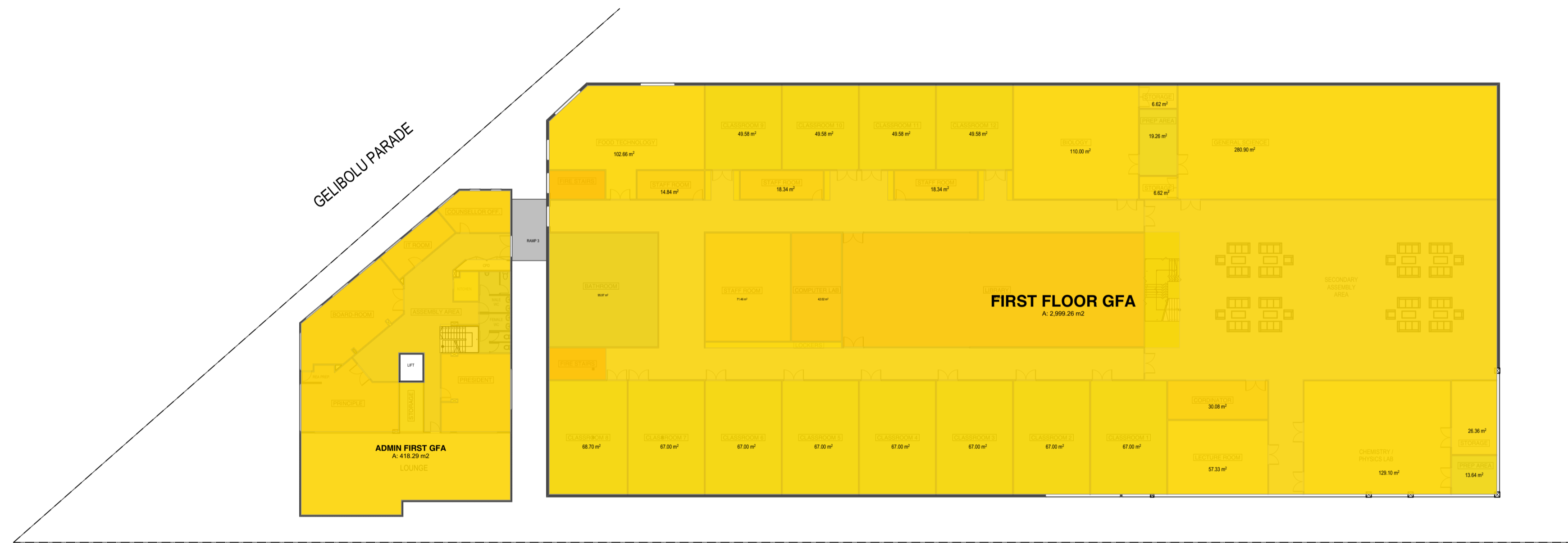

1 FIRST FLOOR - GFA  
1:300

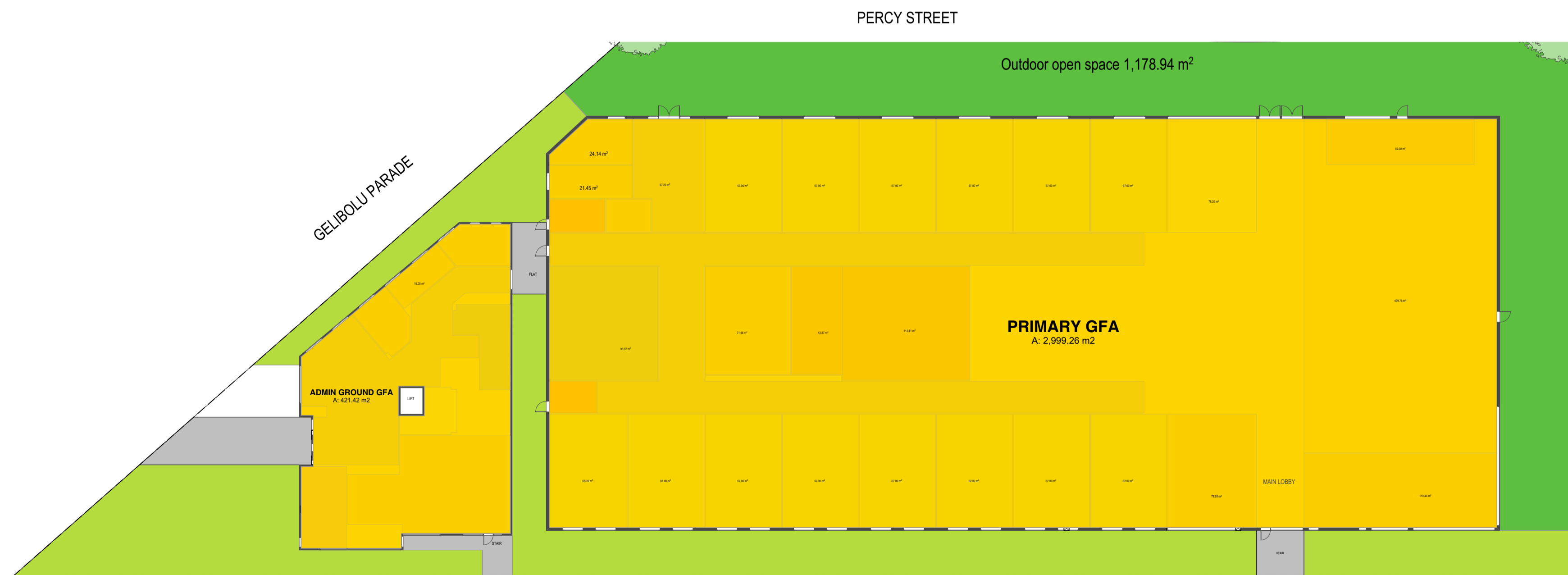

1 GROUND FLOOR - GFA  
1:300

**SITE AREA 7142.7**  
**TOTAL GFA 7142.7**  
**FSR 1:1**  
**PROPOSED LAYOUT**

Rev	Date	Amendment	By	Rev	Date	Amendment	By

**GENERAL NOTES**  
 1. ALL DIMENSIONS AND SIZES ARE IN MILLIMETRES.  
 2. DO NOT SCALE DRAWINGS.  
 3. ALL WALL THICKNESSES DIMENSIONED OR NOTED ARE NOMINAL SIZES ONLY.  
 4. INFORMATION INDICATED IN THIS DOCUMENT MAY BE CRUCIAL TO THE SAFE AND PROPER FUNCTIONING OF THE PROJECT. DO NOT ALTER ANY ASPECT WITHOUT REFERENCE TO THE ARCHITECT.  
 5. READ THIS DRAWING IN CONJUNCTION WITH RELEVANT CONSULTANT DRAWINGS AND SPECIFICATIONS.  
 6. INFORM THE ARCHITECT OF ANY DISCREPANCIES.

- THE WORK IS TO BE COMPLETED WITH THE BUILDING CODE OF AUSTRALIA, SAA CODES AND RELEVANT BY-LAWS.  
 - THE BUILDING / MANUFACTURER SHALL CHECK AND VERIFY ALL DIMENSIONS, RL, GROUND LINES AND CONSTRUCTION METHODS PRIOR TO COMMENCEMENT OF WORK.  
 - PREFERENCES OF DIMENSIONED MEASUREMENT TO BE TAKEN OVER SCALED MEASUREMENTS.  
 - A COPY OF THIS PLAN IS TO BE SUBMITTED BY THE PROPRIETOR TO THE WATERBOARD FOR APPROVAL AS REQUIRED BY THE LOCAL COUNCIL.

ARCHITECTURE DESIGN STUDIO PTY LTD  
 ABN: 43 159 401 420  
 43/8 Avenue Of The Americas  
 Newington, NSW 2127  
 Phone: 02 9648 6663 | Fax: 02 9648 6664  
 email: info@ad-s.com.au

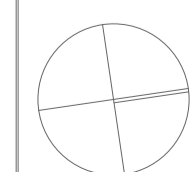

This drawing is protected by copyright. It may only be used for the purpose for which it is issued.  
 A1 Scale 1:500 A3 Scale 1:100  
 0 1 2 3 4 5 10m

Client: Australian Turkish Maarif Foundation Limited  
 Project: Private Educational Institution  
 Address: 2 PERCY STREET AUBURN NSW 2144 AUSTRALIA

Drawing Title: Proposed GFA  
 Date: 19/06/2017  
 Drawing No: A-FE-111-007  
 Project No: Pn\_0648  
 Checked: IS  
 Revision: A



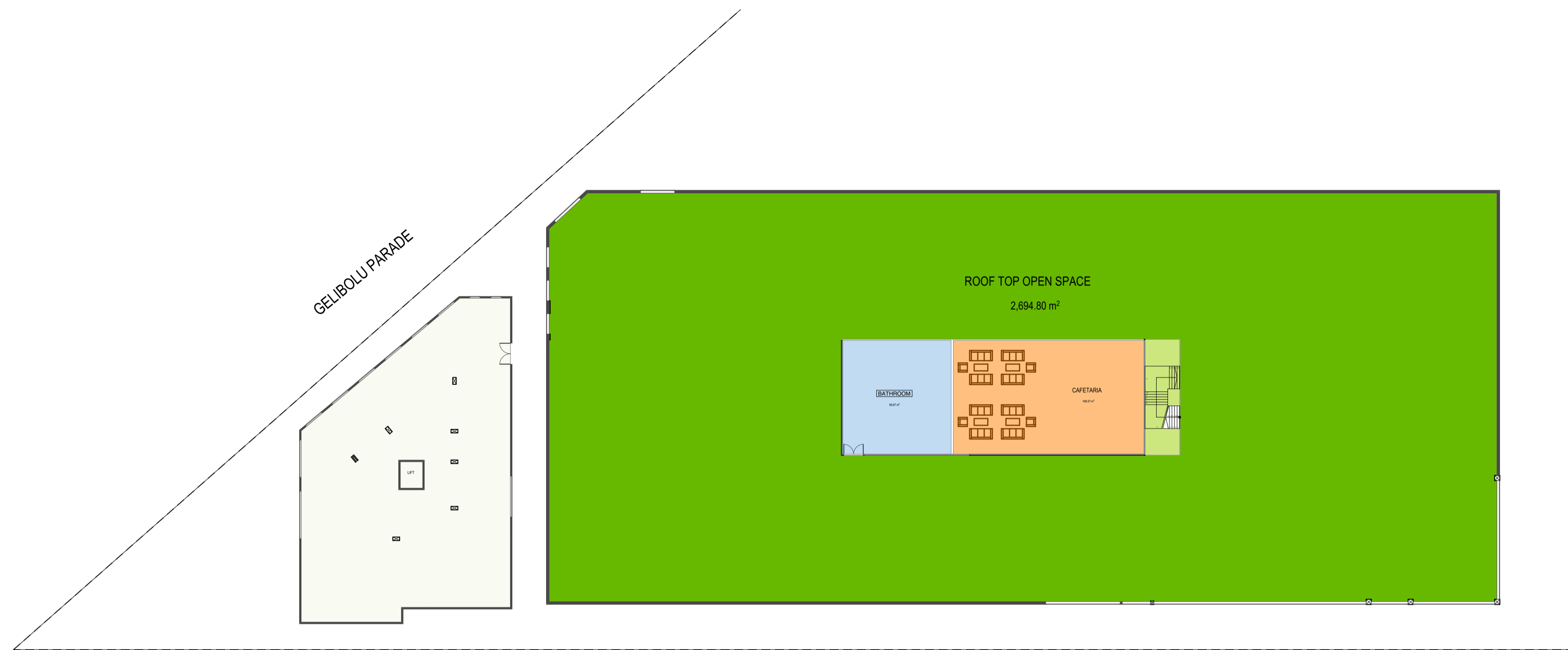

1 SECOND FLOOR  
1:300



1 GROUND FLOOR  
1:300

**SITE AREA 7142.7**  
**TOTAL OUTDOOR AREA 3873.74**  
**PROPOSED LAYOUT**

Rev	Date	Amendment	By	Rev	Date	Amendment	By

GENERAL NOTES  
 1. ALL DIMENSIONS AND SIZES ARE IN MILLIMETRES.  
 2. DO NOT SCALE DRAWINGS.  
 3. ALL WALL THICKNESSES DIMENSIONED OR NOTED ARE NOMINAL SIZES ONLY.  
 4. INFORMATION INDICATED IN THIS DOCUMENT MAY BE CRUCIAL TO THE SAFE AND PROPER FUNCTIONING OF THE PROJECT. DO NOT ALTER ANY ASPECT WITHOUT REFERENCE TO THE ARCHITECT.  
 5. READ THIS DRAWING IN CONJUNCTION WITH RELEVANT CONSULTANT DRAWINGS AND SPECIFICATIONS.  
 6. INFORM THE ARCHITECT OF ANY DISCREPANCIES.

- THE WORK IS TO BE COMPLETED WITH THE BUILDING CODE OF AUSTRALIA, SAA CODES AND RELEVANT BY-LAWS.  
 - THE BUILDING / MANUFACTURER SHALL CHECK AND VERIFY ALL DIMENSIONS, RL, GROUND LINES AND CONSTRUCTION METHODS PRIOR TO COMMENCEMENT OF WORK.  
 - PREFERENCES OF DIMENSIONED MEASUREMENTS TO BE TAKEN OVER SCALED MEASUREMENTS.  
 - A COPY OF THIS PLAN IS TO BE SUBMITTED BY THE PROPRIETOR TO THE WATERBOARD FOR APPROVAL AS REQUIRED BY THE LOCAL COUNCIL.

ARCHITECTURE DESIGN STUDIO PTY LTD  
 ABN: 43 159 401 420  
 43/8 Avenue Of The Americas  
 Newington, NSW 2127  
 Phone: 02 9648 6663 | Fax: 02 9648 6664  
 email: info@ad-s.com.au

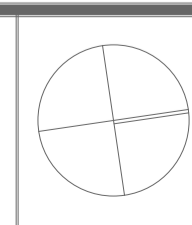

This drawing is protected by copyright. It may only be used for the purpose for which it is issued.  
 A1 Scale 1:500 A3 Scale 1:100  
 0 1 2 3 4 5 10m

Client: Australian Turkish Maarif Foundation Limited  
 Project: Private Educational Institution  
 Address: 2 PERCY STREET AUBURN NSW 2144 AUSTRALIA

Drawing Title		Project No.	
Proposed Outdoor Area		Pn_0648	
Date	19/06/2017	Checked	IS
Drawing No.	A-FE-111-008	Revision	A